

NESTOR project

The X-ray source NESTOR based on the Compton scattering of intense laser beam on low-energy relativistic electron beam is under design and development in NSC KIPT.



Lattice group

- Design of injection channel.
- Lattice optimization of middle energy (40-225MeV) electron storage ring.
- Development of correction system for storage ring and transport channel.
- Simulation of beam orbit displacement in the storage ring due alignment errors.
- Development of special focusing mode without pulsed magnet for the first turn.

K
I
P
T



Nuclear subcritical assembly

The neutron source based on a subcritical assembly driven by a 100 MeV/100kW electron linear accelerator is under construction in NSC KIPT.

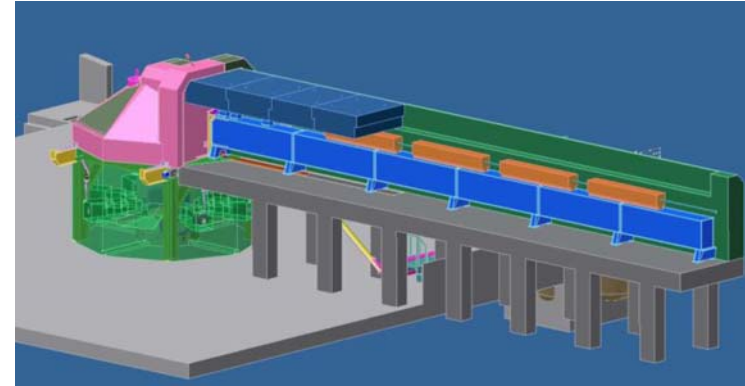

RF group

- Night shifts for commissioning of the klystrons

Lattice group

- Beam dynamics simulation in transport channel from Linac to Nuclear reactor.
- Simulation of beam orbit displacement in the channel due alignment errors of magnetic elements.